

DPX - XACT™ STEERING & STEERING CYLINDERS (SINGLE INSTALLATION)

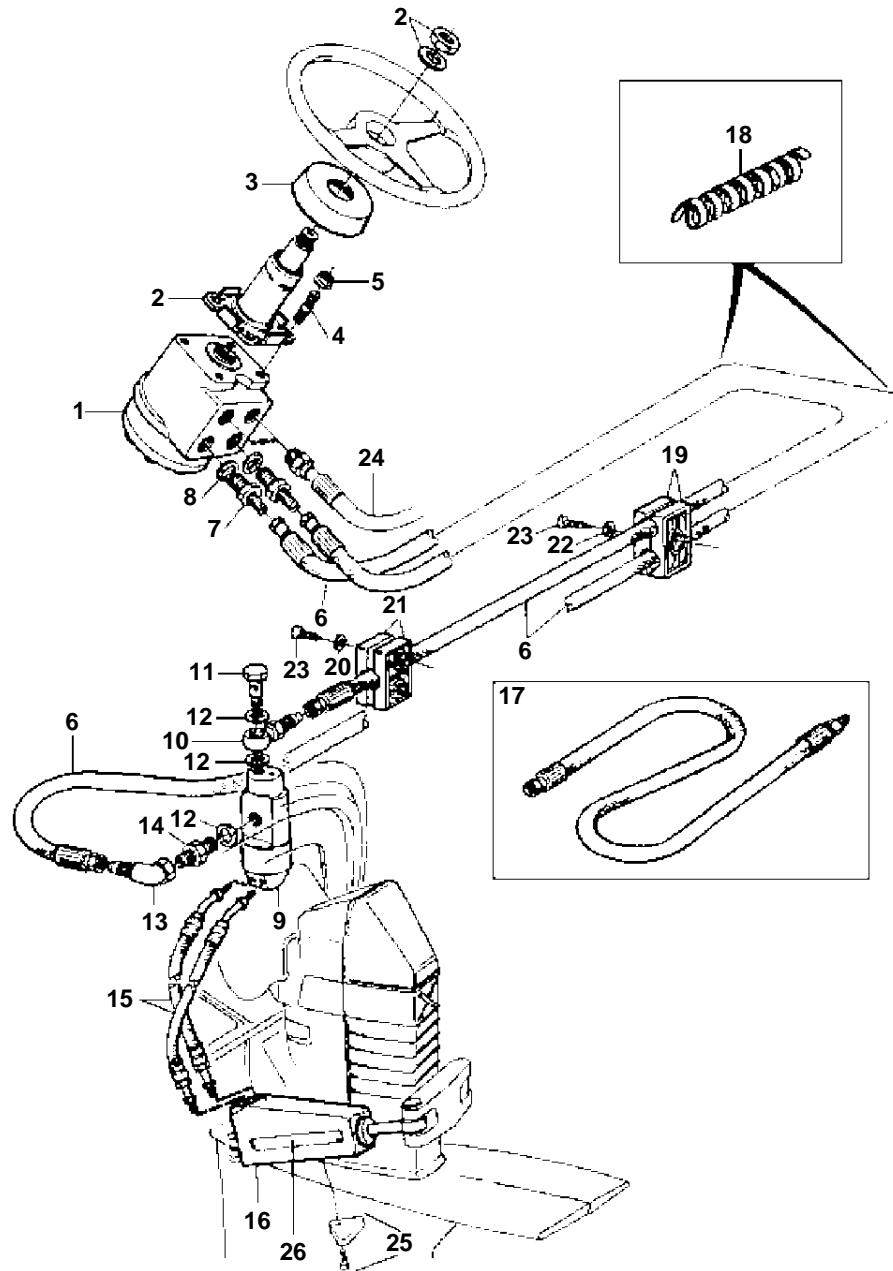

DPX - XACT™ STEERING & STEERING CYLINDERS (SINGLE INSTALLATION)

REF	PART NO.	QTY	DESCRIPTION	NOTES
1	872155	1	Control unit	
2	872157	1	Retainer	
3	873357	1	Cover	
4	924085	4	Stud	
5	971095	4	Nut	
6	872158	2	Hose, L = 6000 mm	
7	873340	2	Nipple	
8	873341	2	Washer	
9	872956	1	Grommet	
10	873325	1	Banjo nipple	
11	873326	1	Hollow screw	
12	873327	3	Washer	
13	873328	1	Elbow nipple	
14	873329	1	Nipple	
15	872593	4	Hose	
16	873231	2	Steering cylinder	Mounted on DPX interm hsg
17	872169	1	Hydraulic hose, L = 1000 mm	
18	873331	1	Coil, L = 500 mm	
19	873335	1	Clamp	
20	873337	1	Washer	
21	873336	1	Clamp	
22	873338	1	Washer	
23	873339	3	Screw	
24	872158	2	Hose, For servo pumps	
25	872793	2	Zinc anode kit	
	872675	2	· Zinc anod	
	963683	2	· Screw	
26	872965	2	Decal, Steering cylinder	

7797470 - - 0-0028

GR71124

Upd: 22 NOV 2005

WT Drives, PJX-C, PJX-S SX-M, -MACLT, -MDA, -MDB, -MHP, -MLT, -MTD, DP-E; DP-S, -S1, -S2; DP-SM, -SM

